

Technical data			
FT 50 C Colour Sensor	FT 50 C-1	FT 50 C-2	FT 50 C-3
Operating range	12 to 32 mm	15 to 30 mm	18 to 22 mm
Scanning range tolerance	± 6 mm	± 5 mm	± 2 mm
Light spot	ø 4 mm	2 x 2 mm	1 x 5 mm
Valid for all FT 50 C sensors:			
Colour scan function	Yes		
Switching frequency	500 Hz		
Size	50 x 50 x 17 mm		
Signal output	3 independently programmable channels		
Outside light protection through pulsed white light	Yes		
Trigger input	Yes		
Pulse stretching	switchable 50 ms		
Current consumption whilst idling	40 mA @ 24V DC		
Max. output current	100 mA		
Protection	IP 67		
Type of connection	8-pin M12 connector		



COLOUR SENSOR

FT 50 C



 **SENSOPART**
SENSORS FOR AUTOMATION

SensoPart
Industriesensorik GmbH
Am Wiedenbach 1
D-79695 Wieden
Tel. +49 (0) 76 73 - 8 21 - 0
Fax +49 (0) 76 73 - 8 21 - 30
<http://www.sensopart.de>

Sensopart UK Limited
G8 The Arch
48 - 52 Floodgate Street
Birmingham B5-5SL
Tel. +44 (0) 121 772 51 04
Fax. +44 (0) 121 772 51 26
<http://www.sensopart.com>

SensoPart France SARL
11, rue Albert Einstein
Espace Mercure
F-77420 Champs - Marne la Vallée
Tél. +33 (0) 1 64 73 00 61
Fax +33 (0) 1 64 73 10 87
<http://www.sensopart.fr>

 **SENSOPART**

FT 50 C – A new ray of light in colour detection

With the FT 50 C colour sensor, SensoPart has set another milestone in the technical development of colour sensor technology: the first colour sensor with only **one light source** in the small standard size, which guarantees the precise **detection of objects in the whole working area**. And which shows many other technical features that make it capable of a top performance as a standard.

The exceptional quality of the FT 50 C is its operational principle with only one light source. The LED emits visible white light. At a large distance range, objects are detected by a patented optical system independently of their shape.

The colour to be detected is learned simply by teach-in and the FT 50 C is at once ready for use. It compares the target object with the taught-in reference colour and if they match, it sets one of the three available switching outputs. By means of 5 adjustable tolerance levels, the FT 50 C can be optimally aligned to the target colour. In addition, the FT 50 C offers the possibility of scanning whole colour ranges. A very flexible method with advantages coming in particularly useful in the case of irregular colour structures in imprints and varnishes.

Field-proven applications

The FT 50 colour sensor simplifies and speeds up sorting and control tasks within a broad spectrum of automated working processes. Whether it is the distinction of the degrees of browning of cookies in the food industry, the positioning of register marks on packings in the pharmaceutical industry or any other detection task: the FT 50 C is the right sensor whenever all the others have had enough of it.



FT 50 C - 3 different light spots to suit your application

FT 50 C - 1 Colour sensor

A tried and tested classic since 2001, the FT 50 C-1 is of course still available. It generates a round light spot of 4 mm in diameter. Suitable for sorting packaging or for checking different types of labels.

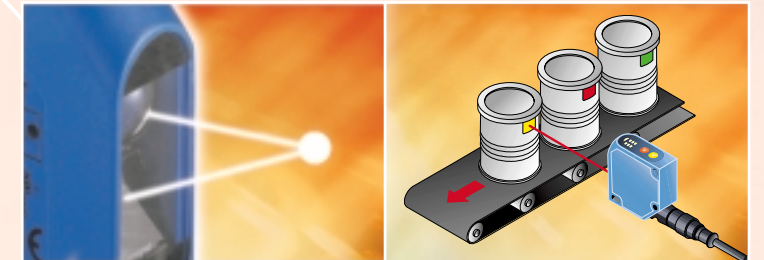

Round light spot \varnothing 4 mm

Detection of different coloured labels

FT 50 C- 2 Colour sensor

Generates a square light spot of 2mm in length. Suitable for the detection of very small objects. Typical applications: sorting of small parts or detection of fine instrument details.

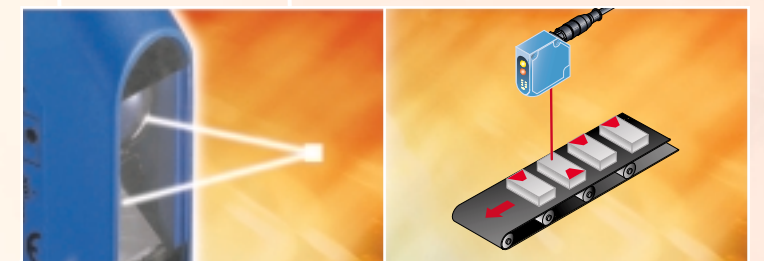

Square light spot 2 x 2 mm

Sorting of small parts

FT 50 C- 3 Colour sensor

Generates a rectangular light spot of 1 mm by 5 mm. Designed for the detection of oblong objects. Typical applications: checking the presence and correct order of stranded conductors in a flat cable.

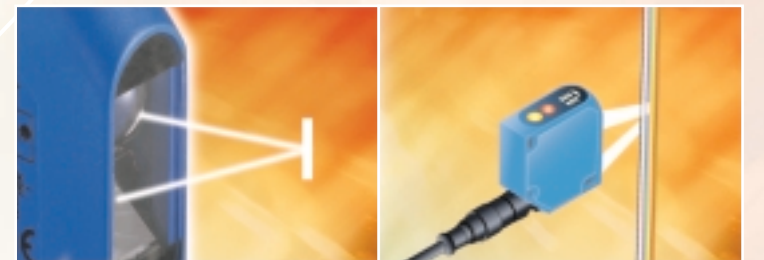

Rectangular light spot 5 x 1 mm

Detection of flat cables